

**FOR LEASE
PREMIUM OFFICE SPACE
100 CONESTOGA COLLEGE BLVD, KITCHENER**

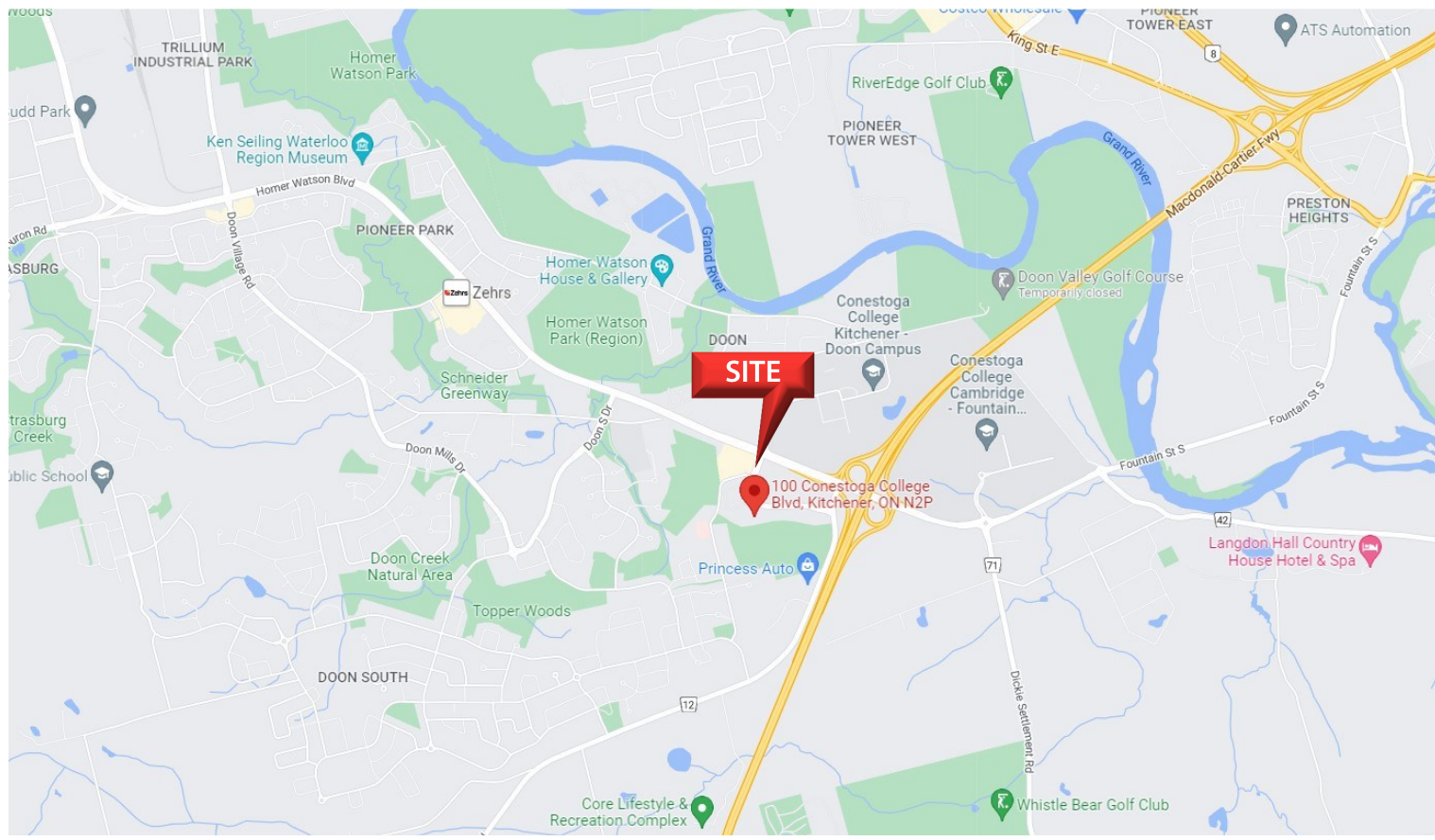

**FOR LEASE
PREMIUM OFFICE SPACE
100 CONESTOGA COLLEGE BLVD, KITCHENER**



PETER KRUSCHEN
SALES REPRESENTATIVE
PETER@COUPALMARKOU.COM
519-742-7000 x 106

**COUPAL MARKOU COMMERCIAL
REAL ESTATE INC.**
150 KING STREET SOUTH
WATERLOO, ONTARIO N2J 1P6
OFFICE 519-742-7000
FAX 519-742-7070

Coupal Markou
Commercial Real Estate Inc., Brokerage
www.coupalmarkou.com

This disclaimer shall apply to Coupal Markou Commercial Real Estate Inc., Brokerage, to include all employees and independent contractors. The information set out herein is for advertising purposes, and any images, assumptions, estimates and property details have been obtained from sources deemed to be reliable. No warranty or representation is made as to its accuracy, correctness and completeness of the information, being subject to errors, omissions, conditions, prior sale / lease, withdrawal or other changes without notice. The recipient of the information should conduct its own inquiries and investigations prior to placing any reliance upon the information. MLS

<p>AVAILABILITY UNIT 1116 - 4,036 SQ FT</p>	<p>* Located On Conestoga College Boulevard, between Homer Watson Boulevard and New Dundee Road</p>	<p>PETER KRUSCHEN SALES REPRESENTATIVE PETER@COUPALMARKOU.COM 519-742-7000 x 106</p>
<p>LEASE RATE \$12.95/SQ FT NET</p>	<p>* First class drive-up 100% finished office space</p>	
<p>ADDITIONAL RENT \$9.00/SQ FT PLUS UTILITIES</p>	<p>* 2 washrooms, 1 board room, open and private office areas, kitchenette and 2 entrances</p>	
<p>ZONING C-6</p>	<p>* Good on site parking at no additional charge</p>	<p>COUPAL MARKOU COMMERCIAL REAL ESTATE INC. 150 KING STREET SOUTH WATERLOO, ONTARIO N2J 1P6 OFFICE 519-742-7000 FAX 519-742-7070</p>
<p>POSSESSION IMMEDIATE</p>	<p>* Great natural light</p> <p>* Fully Air conditioned</p> <p>* Well maintained and managed building</p> <p>* Easy access to 401, south end of Kitchener and Cambridge</p> <p>* Lots of amenities near by</p>	<p>Coupal Markou Commercial Real Estate Inc., Brokerage www.coupalmarkou.com</p>

FOR LEASE

100 CONESTOGA COLLEGE BLVD, KITCHENER

Unit 1116 - 4,036 sq ft

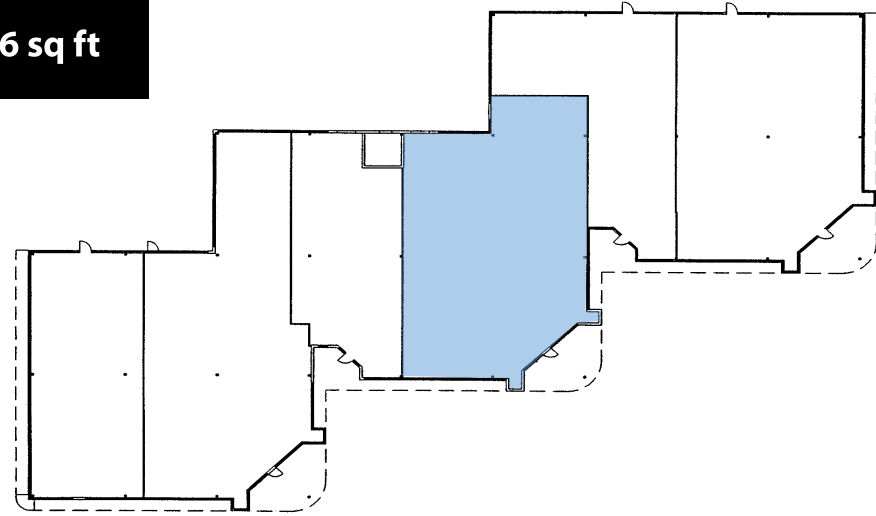

Conestoga College Blvd

