

# 3

## FOR LEASE UNIQUE UPTOWN SERVICE RETAIL SPACE REGINA STREET NORTH, UNIT A, WATERLOO



### AVAILABILITY

A - 5,113 sq ft  
A3 - 1,850 sq ft

### LEASE RATE

\$15.00/sq ft Net

### ADDITIONAL RENT

\$9.50/sq ft  
*Plus Utilities*

### ZONING

U1-81

### POSSESSION

immediate

- \* Located on Regina St N, near the corner of Erb and Regina St
- \* 5,113 sq ft of open concept office space in the central core of uptown Waterloo
- \* Walking distance to many amenities, new condos and LRT stop
- \* High ceilings, exposed brick and duct-work
- \* Lots of windows to provide natural light
- \* Unit provides lots of character
- \* Fully air conditioned

MICHAEL CONRAD  
SALES REPRESENTATIVE  
[MIKE@COUPALMARKOU.COM](mailto:MIKE@COUPALMARKOU.COM)  
519-742-7000 x 105

MATT DICKSON  
SALES REPRESENTATIVE  
[MATT@COUPALMARKOU.COM](mailto:MATT@COUPALMARKOU.COM)  
519-742-7000 x 104

**COUPAL MARKOU COMMERCIAL  
REAL ESTATE INC**  
150 KING STREET SOUTH  
WATERLOO, ONTARIO N2J 1P6  
OFFICE 519-742-7000  
FAX 519-742-7070

**Coupal Markou**  
Commercial Real Estate Inc., Brokerage  
[www.coupalmarkou.com](http://www.coupalmarkou.com)



# 3

## FOR LEASE UNIQUE UPTOWN SERVICE RETAIL SPACE REGINA STREET NORTH, UNIT A, WATERLOO

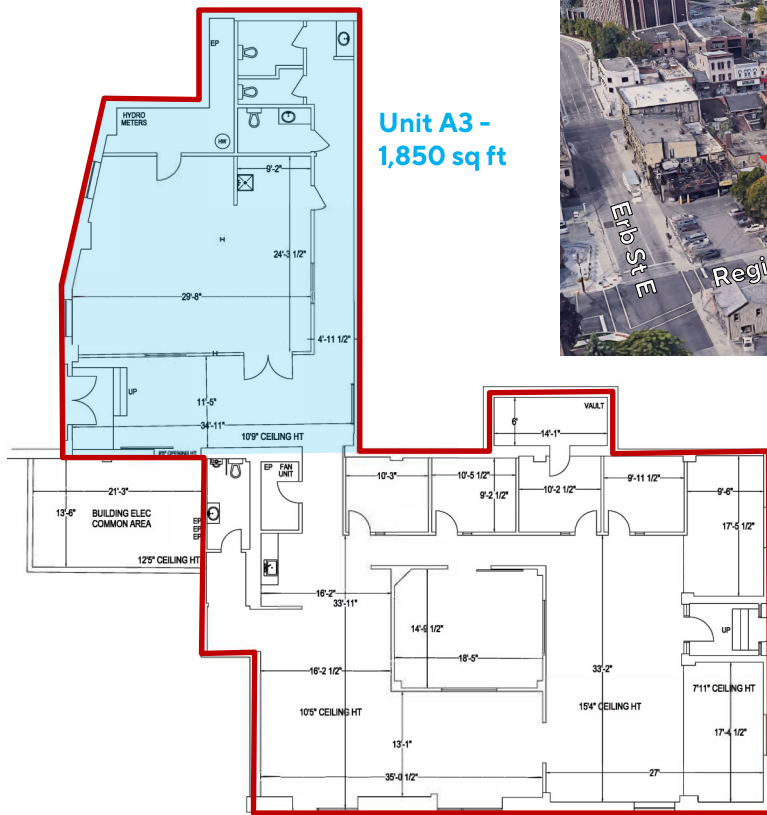
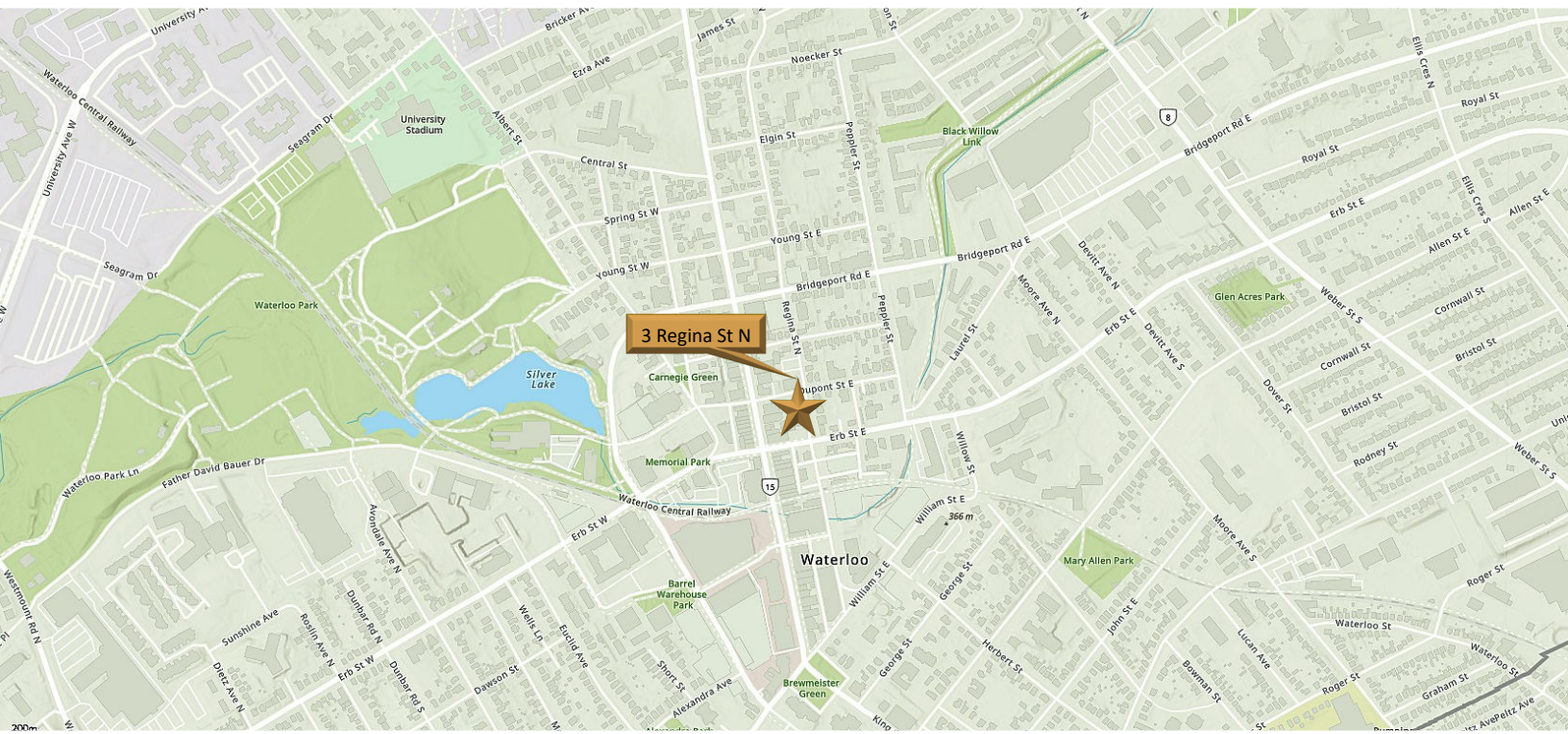

**MICHAEL CONRAD**  
SALES REPRESENTATIVE  
[MIKE@COUPALMARKOU.COM](mailto:MIKE@COUPALMARKOU.COM)  
519-742-7000 x 105

**MATT DICKSON**  
SALES REPRESENTATIVE  
[MATT@COUPALMARKOU.COM](mailto:MATT@COUPALMARKOU.COM)  
519-742-7000 x 104

**COUPAL MARKOU COMMERCIAL  
REAL ESTATE INC**  
150 KING STREET SOUTH  
WATERLOO, ONTARIO N2J 1P6  
OFFICE 519-742-7000  
FAX 519-742-7070



[www.coupalmarkou.com](http://www.coupalmarkou.com)

This disclaimer shall apply to Coupal Markou Commercial Real Estate Inc., Brokerage, to include all employees and independent contractors. The information set out herein is for advertising purposes, and any images, assumptions, estimates and property details have been obtained from sources deemed to be reliable. No warranty or representation is made as to its accuracy, correctness and completeness of the information, being subject to errors, omissions, conditions, prior sale / lease, withdrawal or other changes without notice. The recipient of the information should conduct its own inquiries and investigations prior to placing any reliance upon the information. MLS