

960

Victoria St N, Kitchener

28,738 SQFT
Industrial space



960

Victoria St N, Kitchener



Property Type

Industrial



Parking

30



Price

\$13.50 Per SQFT

TMI

\$3.28 Per SQFT



Clear Height

15^{FT} 10^{IN} – 20^{FT} 10^{IN}

Measured to the joist



Zoning

COM-2

& 108

Provision



Loading Docks

3 Doors

9^{FT} 4^{IN}

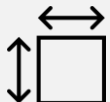

Size (SQFT)

28,738



Drive In Door

1 Door

10^{FT}

960 Victoria Street N in Kitchener, is an impressive structure that is designed to meet the needs of many types of businesses.

The building features a robust exterior with large bay doors and ample parking space for vehicles. Zoned COM-2 allows for the use of industrial and manufacturing and retail businesses, making it a prime location for businesses that require significant space for production, storage, and other operations.

The building itself is spacious and well laid out interior space that can be adapted to suit a wide variety of business needs.

Situated in an excellent area with easy access to major highways and transportation routes. This location offers excellent visibility and accessibility with an array of amenities surrounding its location.

Floor Plan

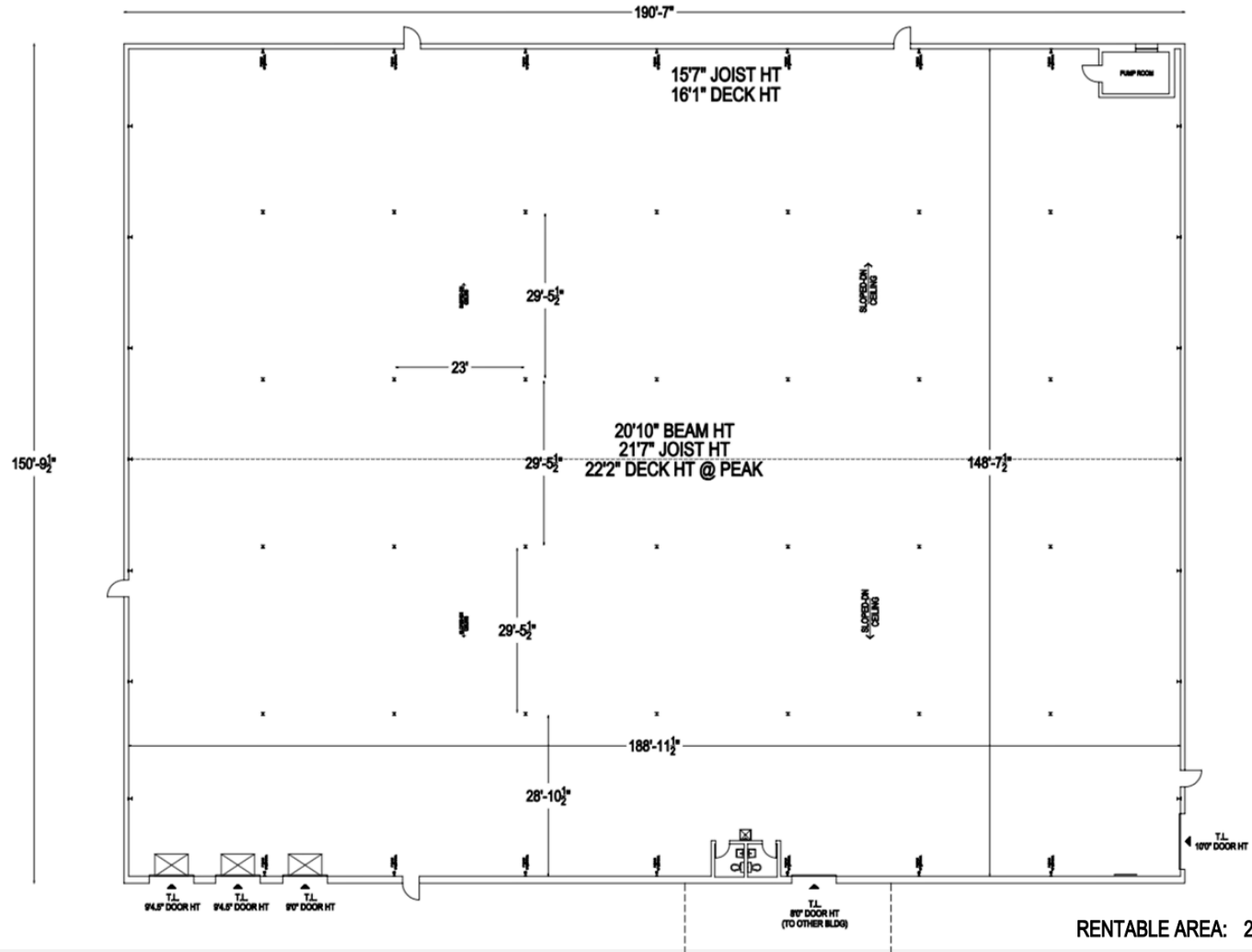

RENTABLE AREA: 28,738 SF



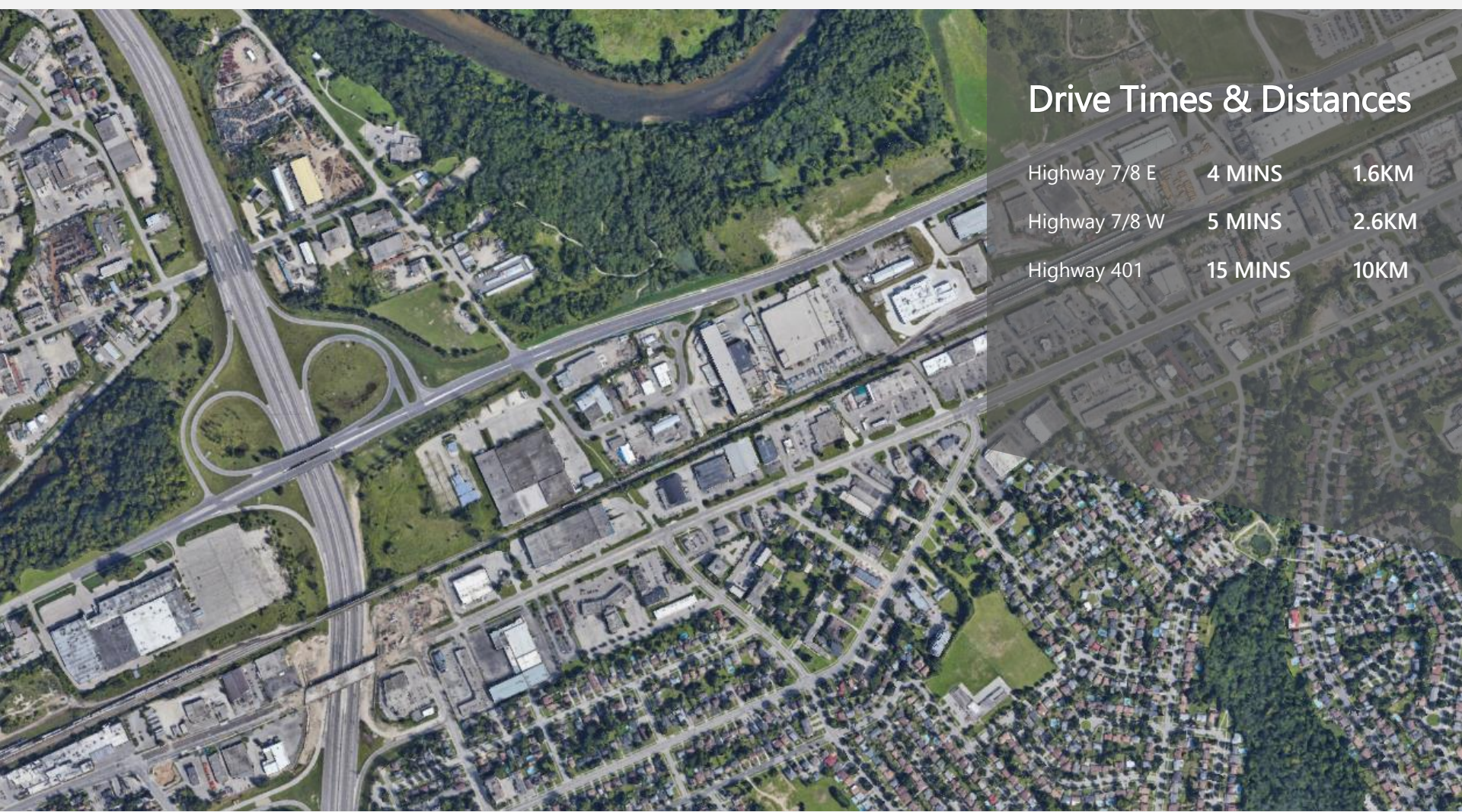

Drive Times & Distances

Highway 7/8 E	4 MINS	1.6KM
Highway 7/8 W	5 MINS	2.6KM
Highway 401	15 MINS	10KM

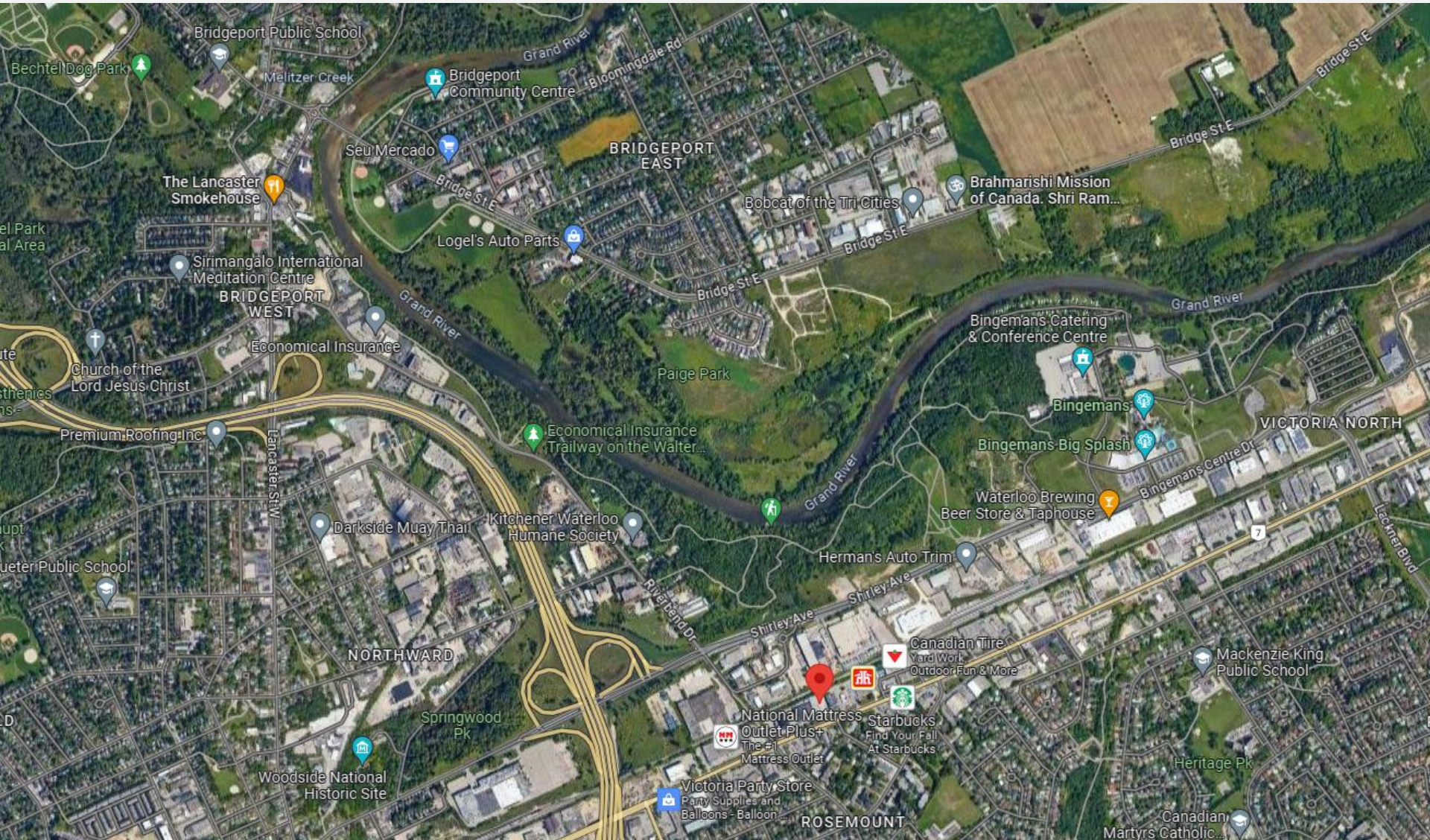

960

Victoria St N, Kitchener

For inquires please contact listing agent

Theo Papadopoulos

Sales Representative

519-742-7000

theo@coupalmarkou.com

This disclaimer shall apply to Coupal Markou Commercial Real Estate Inc., Brokerage, to include all employees and independent contractors. The information set out herein is for advertising purposes, and any images, assumptions, estimates and property details have been obtained from sources deemed to be reliable. No warranty or missions, conditions, prior sale / lease, withdrawal or other changes without nonrepresentation is made as to its accuracy, correctness and completeness of the information, being subject to errors. The recipient of the information should conduct its own inquiries and investigations prior to placing any reliance upon the information.